

AN
AMAZING
STEP IN
FLOORING



hydracork



THE FIRST corktech
LOW THICKNESS
FLOATING PRODUCT

hydracork

AN
AMAZING
STEP IN
FLOORING

THE FIRST **corktech**
LOW THICKNESS
FLOATING PRODUCT

Hydrocork is the ultimate amazing step in flooring offering a low thickness floating solution with all the benefits of floors with Corktech. The Corktech technology enabled the creation of an innovative core board made of composite cork. It is waterproof and incredibly stable, while maintaining the resilient properties and unmatched comfort brought by cork.

+ SILENCE



+ NATURAL
THERMAL
INSULATION



+ WALKING
COMFORT



+ BODY
WELLNESS



+ IMPACT
RESISTANCE

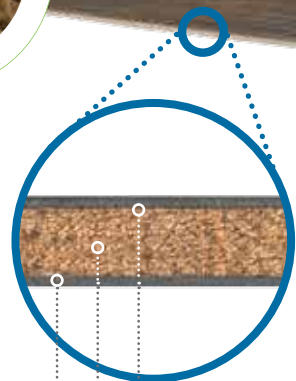

Decorative material
with a protective wear layer

Agglomerate cork
composite core

Underlay
for a balanced structure

1
6mm



IDEAL FOR
RENOVATIONS



WATERPROOF



COMPRESSION
SYSTEM

LIMITED
LIFETIME
WARRANTY



IDEAL FOR RENOVATIONS

The product's low thickness makes it the optimal choice for renovation projects, since Hydrocork can be installed on top of other surfaces, avoiding the need to remove a previously existing floor. This feature is enhanced by the product's low telegraphing effect and easiness of removal.



WATERPROOF

The Hydrocork board is waterproof so it will not swell when exposed to humidity. This means the same visual can be installed in all rooms of a house or building, and the product is also suitable for environments where low maintenance is a requirement.



Alaska Oak

EXPRESS FIT COMPRESSION SYSTEM

PressFit is a revolutionary compression system that takes full advantage of the amazing cork properties - flexibility, elasticity and compressibility - functioning like a cork stopper.

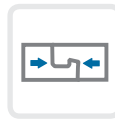

STABLE AND STRONG INSTALLATION

When the product is installed, the cork core generates an internal tension, creating a tight seal and stable installation.



EASY AND FAST INSTALLATION

It only takes two simple steps to install a plank.

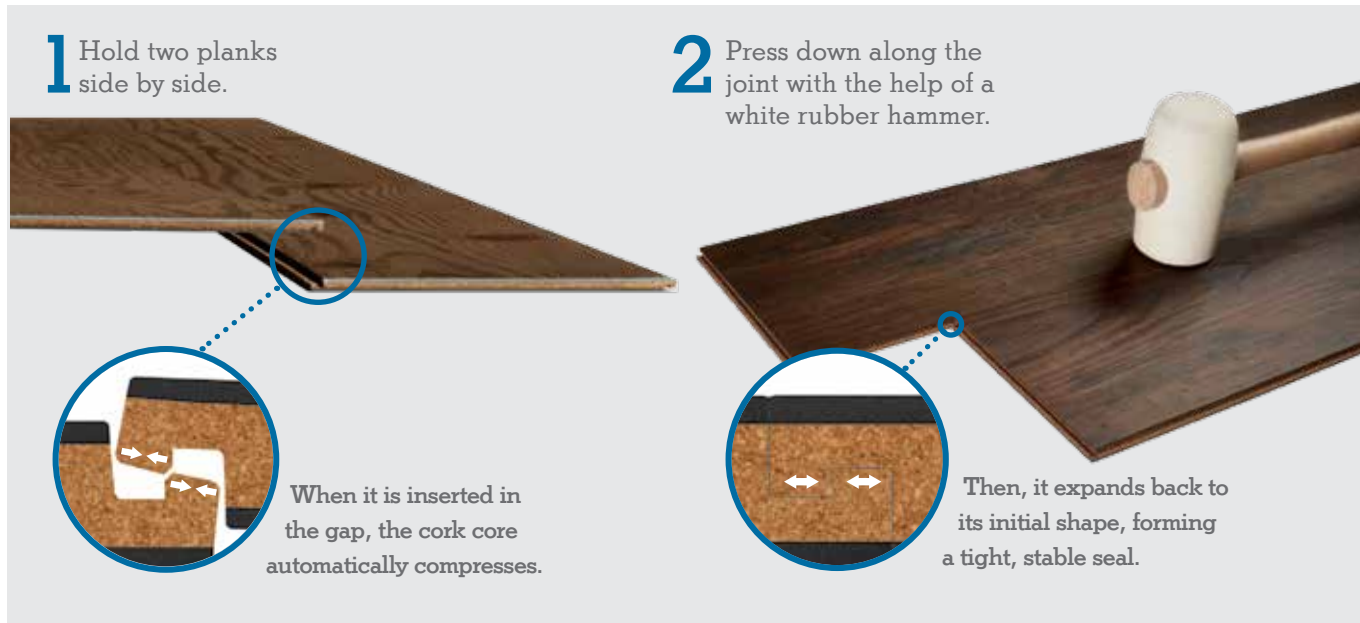

AVAILABLE RANGE

The Hydrocork board is available in 20 luxurious wood looks, suitable for home and commercial environments. Featuring a 0,55mm wear layer, they are adequate both for residential use and heavy traffic commercial spaces.



Light Beech | BST0001 4



Linen Cherry | BSR0001 4



Sand Oak | BSR1001 4



Alaska Oak | BSQ0001 4



Elegant Oak | BSR4001 4



Nature Oak | BST5001 4



Sawn Bisque Oak | BSP3001 4



Sawn Twine Oak | BSP2001 4



Chalk Oak | BSQ1001 4



European Oak | BSQ2001 4



Arcadian Soya Pine | BSP4001 4



Arcadian Rye Pine | BSP5001 4



Castle Raffia Oak | BSP0001 4

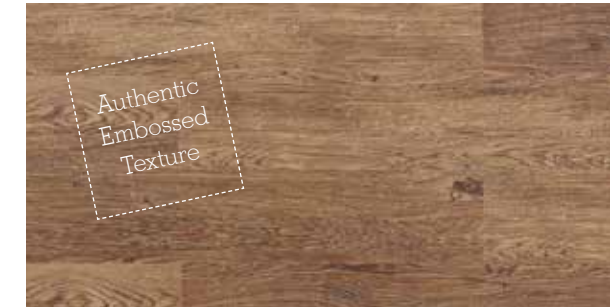

Castle Toast Oak | BSP1001 4



Claw Silver Oak | BSP3001 4



Limed Grey Oak | BST7001 4



Wheat Pine | BSP3001 4



Cinder Oak | BSR7001 4



Century Fawn Pine | BSP7001 4



Century Morocco Pine | BSP6001 4



Claw Silver Oak



Low telegraphing effect



Remarkable Realism



Suitable for Subfloor Heating



Dimensional Stability



Limited Lifetime Warranty* for Residential use.







15 years warranty for Commercial use.



Promotes global sustainability, environmental health, and safety

* Please see the terms and conditions of Wicanders Limited Warranty in the website.

Technical Data Sheet

			Floating Hydrocork 0,55mm Wear Layer 1225 x 145 x 6mm 48 1/4 x 5 11/16 x 1/4"
Domestic	ISO 10874	Class	23  
Commercial	ISO 10874	Class	33  
General properties - ISO 10582 + EN 14085 + EN 14041			
Dimensions:	Standard	Unit	Specification
Width:	ISO 24342	mm	+ 0,10% up to max. 0,5mm
Length:			max. 2,0mm
Overall thickness	ISO 24346	mm	nominal + 0,25
Squareness	ISO 24342	mm	≤ 0,50
Straightness measured at the surface layer	ISO 24342	mm	≤ 0,30
Mass per unit area	ISO 23997	g/m ²	Nominal +13% / -10%
Dimensional stability (humidity)	EN 14085 Annex C/ EN 669	mm	≤ 5
Dimensional stability and curling after exposure to heat	ISO 23999	%	≤ 0,25
Openings between panels	EN 14085 (Annex B)	mm	≤ 0,20
Height difference between panels	EN 14085 (Annex B)	mm	≤ 0,20
Flatness of the panel (Length - Concave / Convex)	EN 14085 (Annex A)	%	≤ 0,50 / ≤ 1,0
Flatness of the panel (Width - Concave / Convex)	EN 14085 (Annex A)	%	≤ 0,10 / ≤ 0,15
Residual indentation	ISO 24343-1	mm	≤ 0,1
Colour fastness	ISO 105-BO2	Blue wool scale	≥ 6
Classification properties - ISO 10582 + EN 14085			
Wear layer thickness (wear layer binder content Type 1)	ISO 24340	mm	0,55
Thickness swelling	ISO 24336	%	≤ 15
Castor chair	EN 425	Visual effect - after 25.000 cycles	No disturbance to the surface other than a slight change in appearance and no delamination shall occur
Simulated movement of a furniture leg	EN 424	Visual effect	No damage shall be visible after testing with a type 0 foot
Safety properties - EN14041			
Fire resistance	ISO 11925-2/ISO 9239-1(classification according to EN 13501-1)	Class	Bfl-s1
Slip resistance	EN13893	Class	DS
Formaldehyde emission	DIN EN 717-1	Class	E1
Content pentachlorophenol (PCP)	EN 14041 Annex B	%	Undetectable
Additional properties			
Stains resistance	ISO 26987 (a)	Grade	Grade 0 (b)
Thermal resistance	EN 12667	(m2K)/W	0,05
Impact sound reduction	ISO 140-8	dB (ΔLw)	16 dB
Walking sound	IHD -W431	dB (A)	Reduction improvement 11,1dB Difference of Loudness 51,1%
Swelling of the joints (Moisture Exposure)	IHD 423	mm	No visible effect
ASTM Standards			
Airborne Sound Transmission Loss	ASTM E90 /ASTM E413	STC (dB)	62 dB
Impact Sound Transmission	ASTM E492 /ASTM E989	IIC (dB)	61 dB
Impact Sound Transmission	ASTM E2179	ΔIIC	18 dB
Smoke Density	ASTM662	KW/m ²	Flaming & Non Flaming ≤ 450
Radiant Panel (Critical Radiant Flux)	ASTM E648	(W/cm ²)	≥ 0,45 W/cm ² Exceeds, Class I
Thermal Resistance	ASTM C177	R-value (m2K)/W	0,0432
Residual indentation	ASTM F1914	%	0,4%
Static Load Limit	ASTM F970	in or mm	≤ 0,005 in (load of 250 lb) ≤ 0,127 mm (load of 113,4 Kg)
Ignition Characteristics of Finished Textile Floor Covering Systems	ASTM D2859	-	Meets the criteria

(a) - The following products were tested: Desinfectant, C₂H₅OH, NH₄OH, Citric acid, iodine, petroleum, spirit
 (b) - Grade 0 - Unchanged / Grade 1 - Very little change / Grade 2 - Little change / Grade 3 - Change / Grade 4 - Strong Change;
 except for iodine = Grade 2

* Please see the terms and conditions of Wicanders Limited Warranty in the website.

DE Amorim Deutschland GmbH (+49) 4221 5 93-01 germany.ar.de@amorim.com
BENE LUX Amorim Benelux B.V. (+31) 166 604 111 info.ar.nl@amorim.com
AT Amorim Deutschland GmbH (+43) 1 54 51 65 10 austria.ar.de@amorim.com
CH Amorim Flooring Switzerland AG (+41) 41 726 20 20 info@amorim.ch
PT Amorim Revestimentos, S.A. (+351) 227 475 600 geral.ar@amorim.com
ES Amorim Revestimentos, S.A. (+34) 902 307 407 info.ar.es@amorim.com
FR Amorim Revestimentos, S.A. (+33) 800 914 848 info.ar.fr@amorim.com
DK Timberman Denmark A/S (+45) 995 252 52 timberman@timberman.dk
PL Dom Korkowy, Sp. z o.o. (+48) 126 379 639 krakow@domkorkowy.pl
US Amorim Flooring North America (+1) 410 553 60 62 info.ar.us@amorim.com
RU Amorim Revestimentos, S.A. (+7) 495 280 7860 info.ar.ru@amorim.com

AMORIM
HeadQuarters
 Amorim Revestimentos S.A
 (+351) 227 475 600
 geral.ar@amorim.com



www.wicanders.com